

Technical specification

Mounting torque: 15 ... 20 Nm
 Ambient temperature: ECT: -25°C ... +125°C
 Cable PVC: -5°C ... +60°C / Cable PUR: -20°C ... +70°C / Cable Raychem: -20°C ... +100°C
 ECTN / ECR: -25°C ... +125°C
 Media temperature: -25°C ... +125°C
 ECT 400bar/5000psi: -10°C ... +125°C
 ECTN 400bar/5000psi: -10°C ... +85°C

Type label description

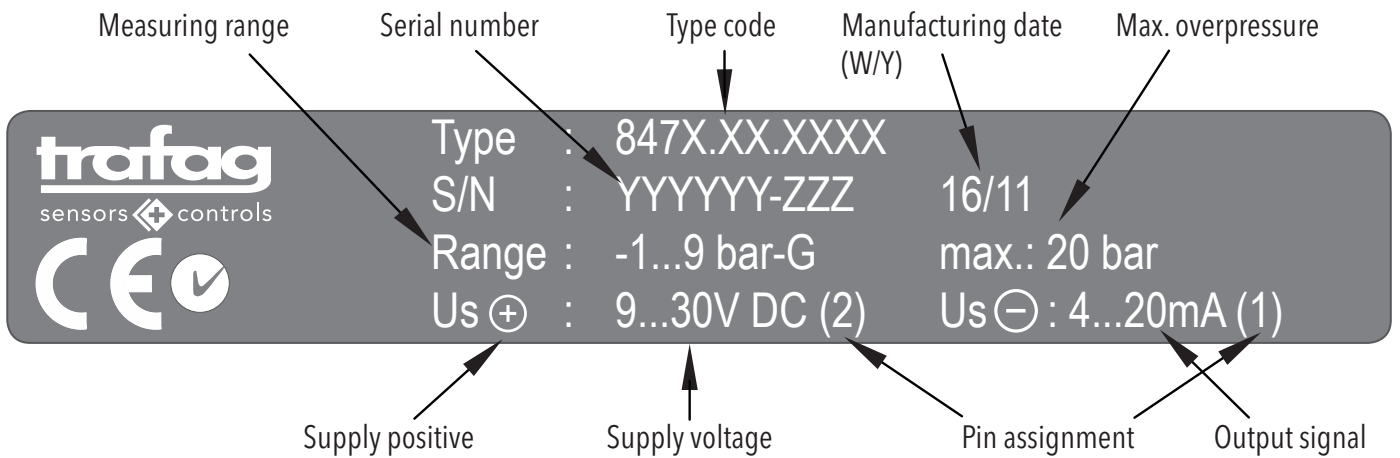

Electrical connections

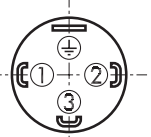
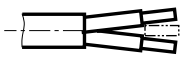
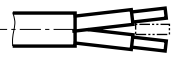
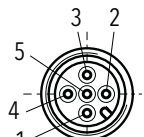
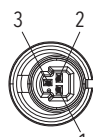
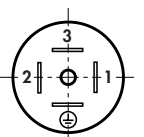
Ingress Protection	IP65 ¹⁾	IP67	IP68 max. 3m	IP67 ¹⁾	IP67 ¹⁾	IP65
Designation	EN175301-803A (DIN43650-A)	Cable* (PVC)(PUR) 4 x 0.25mm ²	Cable* (PVC)(PUR) 4 x 0.25mm ²	M12x1 5-pol.	Packard Metri Pack 3-pol.	Industrial Standard contact distance 9.4 mm
Type code	847X.XX.XXXX.05	847X.XX.XXXX.24/22	847X.XX.XXXX.08	847X.XX.XXXX.35	847X.XX.XXXX.51	847X.XX.XXXX.01
Pin configuration						

Output	Load resistance	I _{SUPPLY}	U _{SUPPLY}
4 ... 20 mA	(U _{SUPPLY} -9V)/ 20mA		9 ... 30 VDC
0 ... 5 VDC	> 2.5 kΩ	<10 mA	10 ... 30 VDC
1 ... 6 VDC	> 5.0 kΩ	<10 mA	10 ... 30 VDC
0 ... 10 VDC	> 5.0 kΩ	<10 mA	15 ... 30 VDC
0.5 ... 4.5 VDC	> 5.0 kΩ	<10 mA	5 VDC ± 0.25 V

¹⁾ provided female connector is mounted according to instructions

* Ventilation via cable end; shield in the device is not connected

Electrical connections

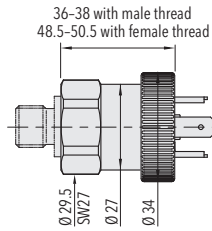

847X.XX.XXXX|05.XX.XX

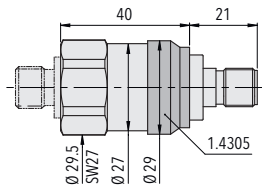

847X.XX.XXXX|35.XX.XX

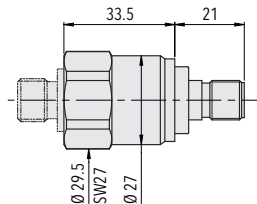

847X.XX.XXXX|35.XX.XX

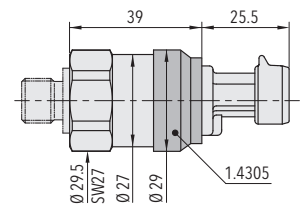

847X.XX.XXXX|51.XX.XX

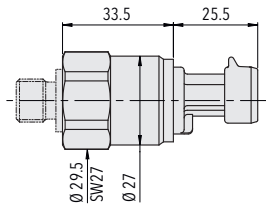

847X.XX.XXXX|51.XX.XX

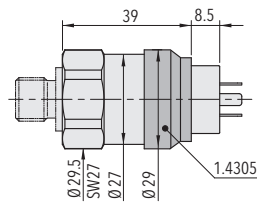

847X.XX.XXXX|01.XX.XX

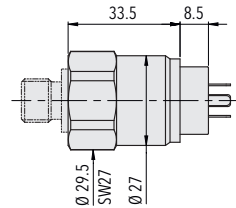

847X.XX.XXXX|01.XX.XX

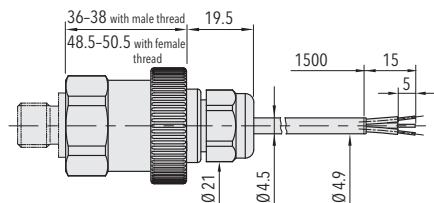

847X.XX.XXXX|22/24/08.XX.XX

Pressure connections

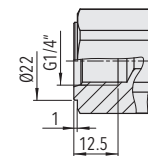

847X.XX.XX|10.XX...

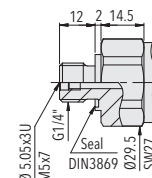

847X.XX.XX|17.XX...

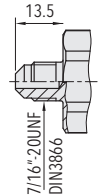

847X.XX.XX|18.XX...

Pressure connections

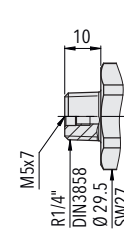

847X.XX.XX|19.XX...

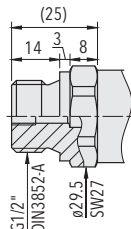

847X.XX.XX|21.XX...

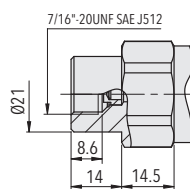

847X.XX.XX|24.05...

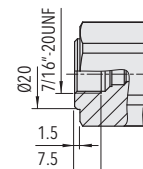

847X.XX.XX|24.XX...

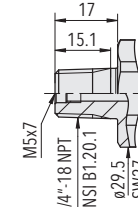

847X.XX.XX|30.XX...

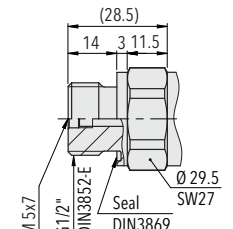

847X.XX.XX|41.XX...

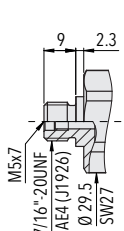

847X.XX.XX|42.XX...

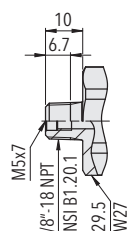

847X.XX.XX|43.XX...

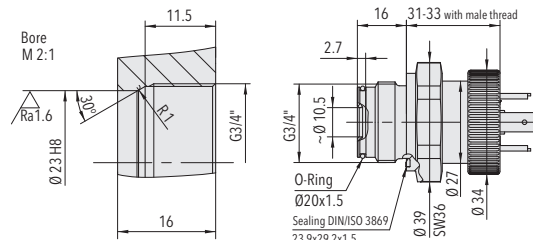

847X.XX.XX|52.XX...

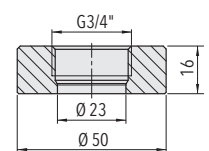

Welding flange for G3/4" frontal membrane (1.4301)
Ordering No. C27805

Connection of the measuring equipment

Current output 2-wires

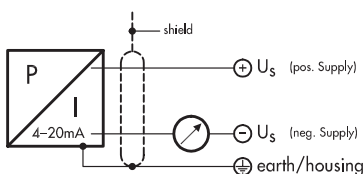

Voltage output 3-wires

